



MONITOR ARM STRELA

ABL's Strela combines value and versatility into a single product solution. The aluminium arm creates a stylish and elegant look adding to any home or office décor. The flexible arm joint and rotating/tilting VESA plate allows the user to adjust the height and angle of monitors, offering the optimum viewing experience. Strela is ideal for virtually any application due to its' ability to easily rotate between portrait and landscape orientation.



FEATURES

- 360° Rotary VESA Plate: for better viewing experience
- Free-Tilting Design: for multiple monitor viewing angles
- Built-in Cable Management: for an organized and neat workspace
- Aluminium Construction: provides a sleek, lighter, and elegant look
- Quick-Release VESA Plate: for easy installation
- Keyhole Pattern: allows easy installation
- Swiveling Arm(s): offer(s) maximum viewing flexibility
- Available colours



Screen size
17" - 32"



Tilt Range
+30° ~ -30°



Swivel Range
+90° ~ -90°



Screen Rotation
+180° ~ -180°



VESA Compatible
75x75 & 100x100



Curved
Monitor



Cable
Management

MOUNTING INSTRUCTIONS





MONITOR ARM STRELA

SPECIFICATIONS

Product Category:	Articulating Monitor Arm
Rank:	Budget
Material:	Aluminium, Steel
Surface Finish:	Powder Coated
Colour:	Matt Black, Matt White, Silver
Box dimensions:	117x510x498mm for single and 886x124x498mm for double
Fit Screen size:	17"-32"
Fit Curved Monitor:	Yes
Weight Capacity (per screen):	0 - 8kg
VESA Compatible:	75x75, 100x100
Tilt Range:	+30° ~ -30°
Swivel Range:	+90° ~ -90°
Screen Rotation:	+180° ~ -180°
Arm Full Extension:	386mm
Installation:	Clamp
Suggested Desktop Thickness:	5-60mm
Quick Release VESA Plate:	Yes
Cable Management:	Yes

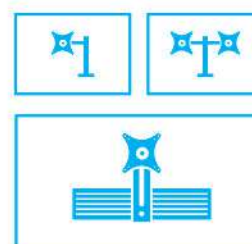

Available as single, double and tool rail

DIMENSIONS

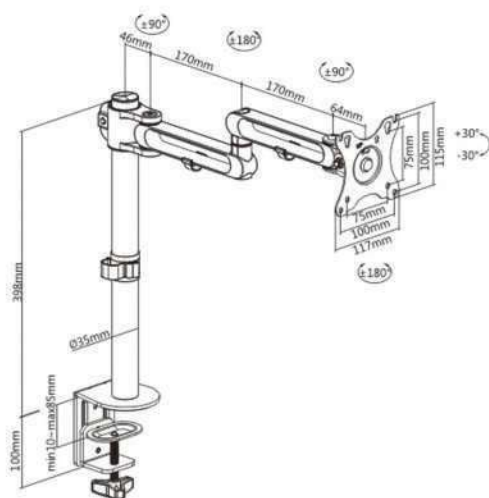

SINGLE

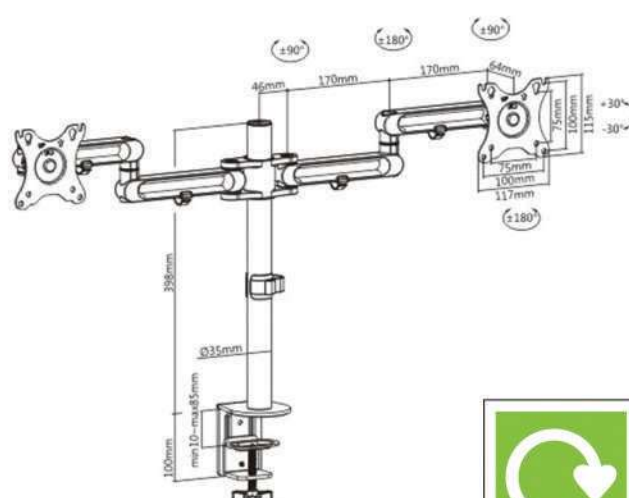

DOUBLE

