

Axis65

ON desk power solutions



Axis65 is a compact on-desk power module designed for modern workspaces.

It combines a single AC power socket with USB C+C 65W charger, delivering essential connectivity in a clean, minimal form.

Easy to install with a C-clamp system. This fits desk thickness from 10–38 mm and integrates seamlessly into any environment.

Axis65 - Essential power, refined.



AVAILABLE SOCKET TYPES:



E TYPE F TYPE G TYPE USB CHARGER



65W Upper USB C Charger only

20W Lower USB C Charger only

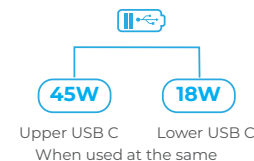

FASCIAS ● ○ BODY ● ○

USB

- ONE POWER SOCKET (SCHUKO, UK OR FRENCH/BELGIAN)
- ONE USB C+C PD 65W CHARGER FOR FAST CHARGING
- THE MODULE USES AN EASY-TO-FIT C CLAMP
- FITS DESK THICKNESS BETWEEN 10 - 38 MM
- OPTIONALLY AVAILABLE WITH A CLAMP FOR UNDER-DESK INSTALLATION
- ALL STANDARD OPTIONS COME WITH A 0.5M DROP LEAD TO 3 POLE CONNECTOR
- AVAILABLE IN BLACK OR WHITE, NATURAL ALUMINIUM BODY
- COMPLIES WITH THE BSI KITEMARK KM 686563 (UK), IEC 60884-1:2002 + A1:2006 AND IEC 60884-2-7:2011 + A1:2013 (EUROPE)

APPROVALS & CERTIFICATES:





INSTALLATION

Standard top fix:

STEP 1. Place the clamp onto the edge of the desk and tighten it using Allen Key.

STEP 2. Slide the module onto the clamp.

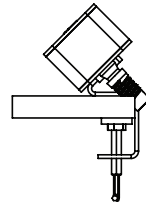
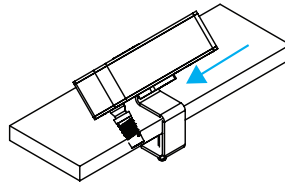
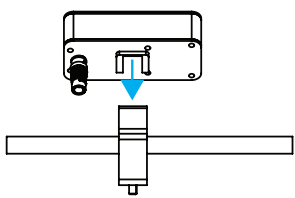
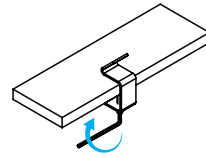

Note: Optionally available with a clamp for **under-desk installation**.

STEP 1. Slide the module onto the clamp.

STEP 2. Secure the clamp with the module using the supplied screws, aligning them with the designated fixing points on the clamp.

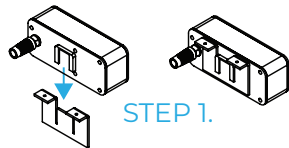

STEP 1.

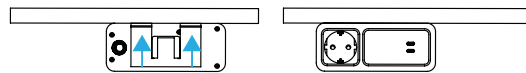

STEP 2.

STANDARD DIMENSIONS

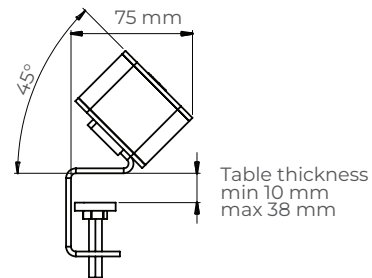
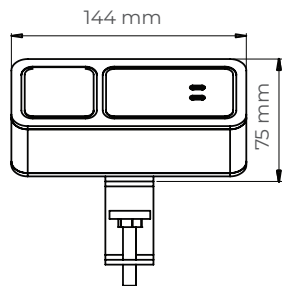

TECHNICAL

Configuration:

Power / USB C+C chargers (PD & QC) / Combined

Earthing: Fully earthed

Fusing: UK type socket with resettable 3A thermal fuse

Power cord: 0.5 m standard lead with 3 Pole connector allows mains or connector leads to be attached to suit requirements, especially useful during moves and changes. Alternative available with a hardwired cable with appropriate national mains plugs.

Testing: 100% testing - continuity, polarity & earth

Testing of the USB PD & QC chargers: Output voltages, electrical current, and power in all types of charging standard.

All Axis65 power modules are fully manufactured in-house using ISO 9001:2015 quality-controlled practices.

Our certified power modules are tested in accredited laboratories of certification houses twice a year; while in-house quality control testing of each product is completed on every single power module before it leaves the factory.